

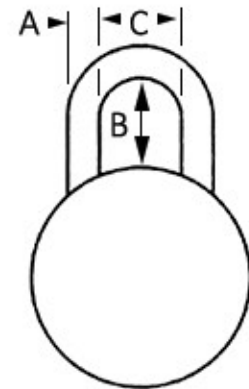

Size Specification (Model: 1525)



Shackle Sizes

- A - 7mm
- B - 19mm
- C - 21mm



Features

- Prefixed number combination codes
- Master key control
- Equipped with Blockguard Anti-Shim Padlock Technology that withstands attempts of violating the latch mechanism
- Includes combination chart
- 1- 7/8" (48mm) wide double-reinforced stainless steel body
- 3/4" (19mm) tall, hardened steel shackle
- Easy 3 number dialing with automatic scrambling feature
- Ideal application for schools, hospitals, hotels, restaurants, recreational places, etc.

3S COIN RETURN LOCK



Size Specification

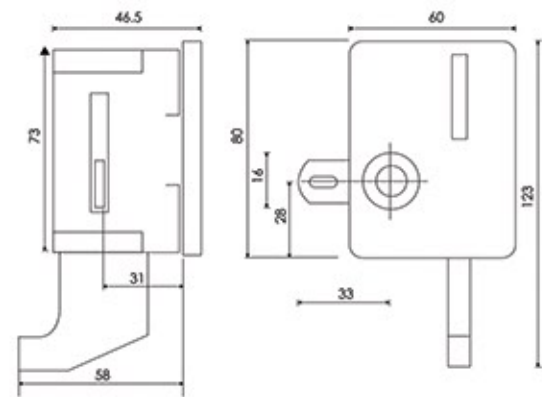

All dimensions in mm
All dimensions subject to changes without prior notice.



Features

- Work solely on coin return mode
- Mechanically operated
- Replaceable key cylinder
- Comes with master key and installation key
- Made of durable plastic material
- Suitable for all types of lockers / doors - 1- 20mm wooden / metal / laminate
- Ideal application for schools, factories, hotels, restaurants, recreational place, etc.



Locker & Lock Sdn Bhd (Co. Reg. 479434-V)

Lot 773, No 10B/11B Jalan Subang 4, Subang Light Industrial Park,
47500 Subang Jaya, Selangor
Tel: +60 3 8081 5725 Fax: +60 3 8081 5726

L1-19, Block A, Akademik Suite, Jalan Austin Heights Utama
Taman Mount Austin, 81100 Johor Bahru, Johor
Tel: +60 7 364 3219 Fax: +60 7 364 2319
Email: sales.my@lockerandlock.com